

## BYT 7LP / FLAT 7LP

2 izbový byt / 2 rooms flat

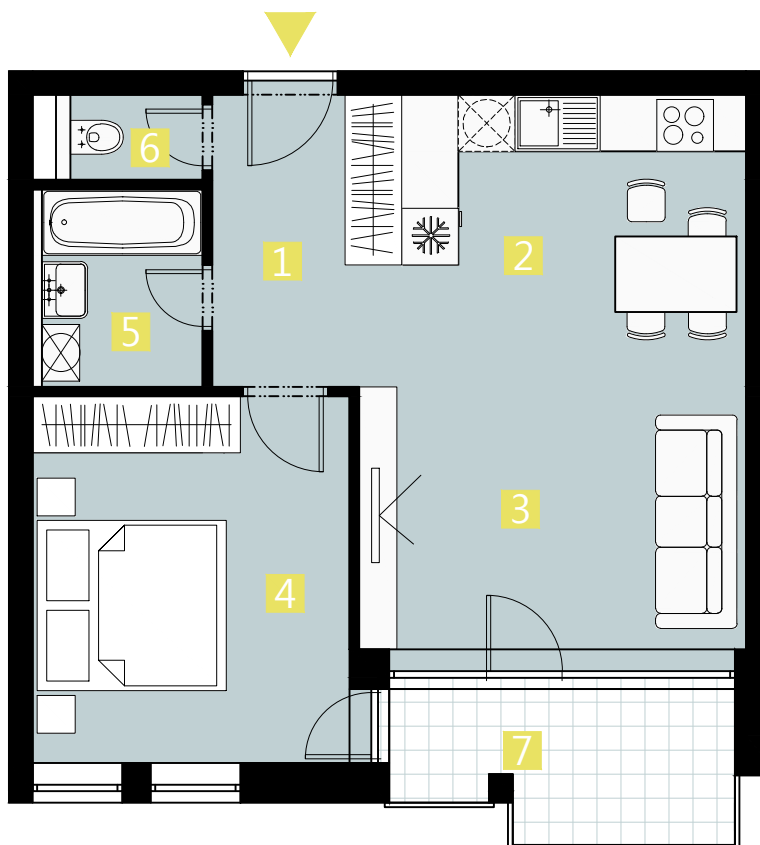

|                     |               |                          |
|---------------------|---------------|--------------------------|
| 1. vstupná predsieň | / lobby       | 0 6 , 0 9 m <sup>2</sup> |
| 2. kuchyňa          | / kitchen     | 1 1 , 8 4 m <sup>2</sup> |
| 3. obývacia izba    | / living room | 1 2 , 2 3 m <sup>2</sup> |
| 4. izba             | / room        | 1 3 , 2 0 m <sup>2</sup> |
| 5. kúpeľňa          | / bathroom    | 0 3 , 7 6 m <sup>2</sup> |
| 6. wc               | / wc          | 0 1 , 6 2 m <sup>2</sup> |
| 7. loggia           | / loggia      | 0 5 , 9 0 m <sup>2</sup> |

**CELKOVÁ PLOCHA / TOTAL 48,74 m<sup>2</sup>**



s c h é m a p ô d o r y s u 7 . N P  
/ s c h e m e o f t h e s e v e n t h f l o o r

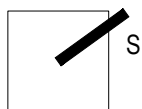

0 1 2 3 4 5 M 1 : 8 0

I pôdorys je spracovaný na marketingové účely I zariadenie predmety a ich rozmiestnenie má len ilustračný charakter  
I floor plan is processed for marketing purposes I furniture and its placement is only for illustration